



Model HC (Dry)

Pneumatically
or Hydraulically
Actuated
Clutches



 **Wichita**[®]
Clutch

An Altra Industrial Motion Company



Model HC (Dry)

The Model HC (Dry Lining) clutches are designed to be used in either an end of shaft or through shaft mounting configuration. The use of 24 bar hydraulic actuation and multiple dry organic lined friction plates provides a clutch range with very high torque capability relative to overall diameter. The end result is a clutch that is compact dimensionally, whilst providing high torque solutions in the smallest envelope space.

The Model HC(D) clutches are provided with an internally splined outer drive ring for bolting to the users driving or driven member. The clutch can also be supplied without an external drive ring to allow for customers to incorporate the external drive spline within a component of their own manufacture. This possibility enables designs where minimal axial space is desirable, by allowing the clutch to fit within the customers driving or driven component.

Actuation pressure may come from either a pneumatic or hydraulic source. This pressure may be introduced through an axial hole provided at the shaft centreline, or, in the case of end shaft mounts, it may be introduced through a separate manifold.

All Torque transmitting members are designed to provide for continuous heavy duty industrial service. Hubs and drive rings are fully hardened and manufactured from high quality alloy steel forgings. Disc pack cores are designed using extra-heavy plate thicknesses to maximise torque and heat capacity.

Friction materials designed to provide for high thermal load acceptance and smooth engagement performance.

The clutch range is designed for use in harsh external environments benefitting from a completely enclosed design and incorporating a dust / water ingress seal between the rotating components. This makes it ideal for applications open to the elements. Optional 2 pack epoxy paint finishes provide additional protection and can be specified if required.

Winch connect / disconnect drives, conveyor or mill drives and multi-speed transmissions are but a few of the applications for the model HC/HCD dry lined clutch range.

Operational Data

Clutch Model	Dynamic ¹⁾ Torque (Nm)	Static ¹⁾ Torque (Nm)	Actuator Volume (cm ³)	Weight Outer (kg)	Weight Inner (kg)	MR ² Outer (kgm ²)	MR ² Inner (kgm ²)	Maximum ²⁾ RPM
HC-8-6	15525	18628	72	8	28	0.05	0.05	2600
HC-10-6	20550	24468	120	16.5	41.1	0.29	0.35	2200
HC-13-6	56110	66045	230	39	100	0.38	1.61	1700
HC-15-6	90205	106126	311	148	87	3.20	4	1450
HC-18-6	155802	178945	508	120	210	8	5.8	1200
HC-20-6	278410	320626	836	195	375	15.50	11.40	1100

1) Torque values specified are based upon an actuation pressure of 24bar hydraulic.

2) For maximum allowable clutch dynamic engaging speed, consult Wichita.



Dimensional Data

Clutch Model	A	B	C	D	E	F	Max. Bore G	Connection Threads H
HC-8-6	257	222	211	13	150	108	76	12 x M10
HC-10-6	298	264	249	14.2	166	117	100	12 x M10
HC-13-6	430	365	351	18.3	213	129	150	24 x M20
HC-15-6	513	418	400	19.8	240	157	165	24 x M24
HC-18-6	600	495	473	38	290	188	200	36 x M20
HC-20-6	660	546	524	44.4	312	201	230	36 x M24

Dimensions subject to change without notice. Use certified drawings only for final layouts.

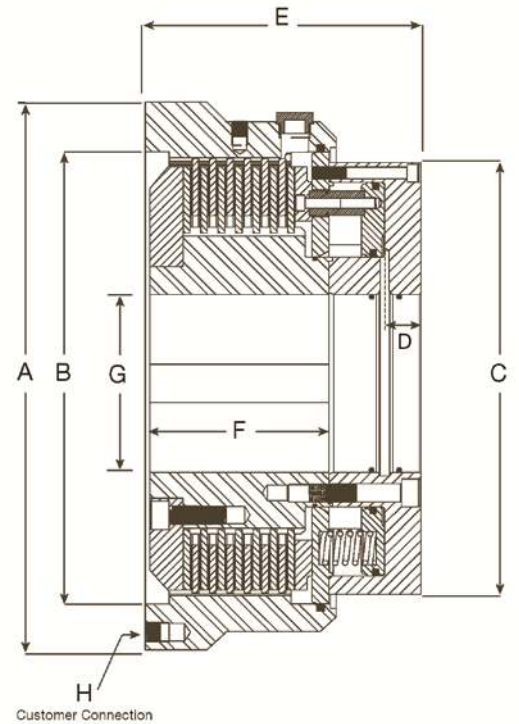

Standard 'through shaft' oil feed for actuation. 'O' ring sealing on shaft.

Actuation Oil Supply Options:

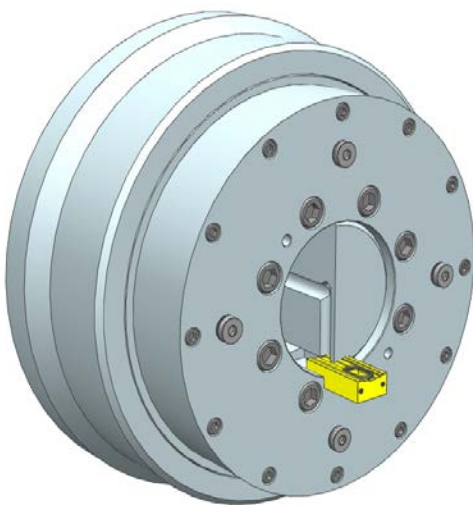

Patented "Insert Seal Key"

- Can be fitted after the unit is secured on the shaft
- Minimum axial space required



Direct cylinder hose feed

- Cross drilled shaft and hoses

Worldwide Distributors

Worldwide Support and Distributors

Argentina

TEKMATIC
(54114) 222-5040
(54114) 201-2478
info@tekmatic.com.ar

Australia

**Altra Industrial Motion
Australia (Pty) Ltd**
+61 2 9894 0133
+61 2 9894 0368
sales@wamerelectric.com.au

Austria

Bibus Austria
+43 2242 33388
+43 2242 3338810
info@bibus.at

Belgium

AZ Hollink
+32 (0) 3 722 11 18
+32 (0) 3 722 11 19
info@azhollink.be

Brazil

**KALATEC
AUTOMACAO**
(55193) 242-4797
(55193) 243-4316
kalatec@mpc.com.br

WAD EQUIPAMENTOS
(55313) 439-3439
(55313) 749-2129
wadventas@terra.com.br

Chile

CORYMAR
(563) 268-2807
(563) 297-8470
corymar@entelchile.net

KUPFER

(562) 696-5476
(562) 211-9801
akupfer@abkupfer.cl

Columbia

INDELEC LTDA.
(572) 683-3063
(572) 660-2064
indelec@indelec.com.co

JUAN ARIAS

1 954 603 6334
(571) 615-2420
juan.arias@altramotion.com

Sensores y Equipos
(574) 256-8301

WARNER INDUSTRIAL

(571) 679-3323
(571) 679-6672
warnerind@tutopia.com

Czech Republic

Bibus s.r.o.
+42 547 125 300
+42 547 125 319
bibus@bibus.cz

Denmark

AVN Automation A/S
+45 70 20 04 11
+45 86 80 55 88
fb@avn.dk

Ecuador

HIVIMAR Av.
(5934) 268-1100
(5934) 268-1199
info@hivimar.com

Egypt

Itaco
+ 20 2 2272 5754
+ 20 2 2273 7245
itacou@link.net

Eire

Torsion Dynamics Ltd
+353 1 846 1677
+353 1 846 1688
torsion@iol.ie

Finland

Knorring Oy AB
+358 9 56041
+358 9 565 2463
knorring@co.inet.fi

France

Société Fogex
+33 1 34 34 46 00
+33 1 34 34 46 01
info@fogex.com

Germany

**Stieber GmbH Abt.
Wichita**
+49 6221 3047 19
+49 6221 3047 17
sales@stieber.de

Greece

Dimitrios Deliyannis
+301 0610 8581
+301 0610 8583
delathen@ath.forthnet.gr

Hong Kong

**Altra Industrial Motion
Shui Hing Ltd**
+852 2615 9313
+852 2615 9162
info@altramotion.com.cn

Hungary

Bibus Kft
+36 1 265 2733
+36 1 264 8900
info@bibus.hu

India

**Francis Klein & Co.
Pvt. Ltd**
+91 20 255 397 70
+91 20 255 397 71
fkleinpune@francisklein.in

Israel

**Larom Import
Marketing**
+972 499 37333
+972 505 239552
avi@larom-marketing.co.il

Italy

**Bianchi Cuscini-
netti, Componenti E
Trasmissioni SpA**
+39 02 678 61
+39 02 670 1062
info@bianchicuscinetti.it

Japan

Japan Wichita Co Ltd
+ 81 3 3456 1461
+ 81 3 3456 1484
info@japanwichita.co.jp

Mexico

**Industrial Magza,
S.A. de G.V**
68-63-28-31/55-60-00-53
55-60-07-56
magza@eclips.com.mx

New Zealand

**Altra Industrial Motion
Australia (Pty) Ltd**
+61 2 9894 0133
+61 2 9894 0368
sales@wamerelectric.com.au

Norway

Betamo A S
+47 6927 5510
+47 6927 4550
benghans@c2i.net

Peru

BC Bearing Peru
(51 1) 561-9868
ventas-stgo@bcbearing.cl

Philippines

**Altra Industrial Motion
(Singapore) Pte. Ltd**
+ 65 6487 4464
+ 65 6487 6674
sales@wamerelectric.com.sg

Poland

**Bibus Menos Sp.
z.o.o.**
+48 58 660 95 70
+48 58 661 71 32
info@bibusmenos.pl

Portugal

**Pinhol, Gomes &
Gomes Lda**
+ 351 21 425 6850
+ 351 21 425 6859
import.export@pinhol.
com.pt

Singapore

**Altra Industrial Motion
(Singapore) Pte. Ltd**
+ 65 487 4464
+ 65 487 6674
sales@altramotion.com.sg

Slovakia

Bibus SK s.r.o
+421 37/777 79 11
+421 3765 16701

Slovenia

INOTEH d.o.o.
+38 626 651 131
+38 626 652 081
info@inoteh.si

South Africa

**Sintech Torque
Control**
+ 27 11 823 2359
+ 27 11 823 2387
sales@sintech.co.za

Spain

**S.I.T. Sociedad
Industrial De
Transmisiones, SA**
+34 943 45 7200
+34 943 46 3356
atencioncliente@sitsa.es

Sweden

**LÖNNE
SCANDINAVIA AB**
+46 (0) 42 38 03 00
+46 (0) 42 38 03 09
info.sweden@lonne.com

Switzerland

Laesser AG
+41 62 791 6841
+41 62 791 3903
info@laesser-ag.ch

Taiwan

**Warner Electric
(Taiwan) Ltd**
+ 886 2 577 8156
+ 886 2 570 6358
sales@altramotion.
com.tw

Thailand

**Altra Industrial Motion
(Industrial) Ltd**
+ 662 322 5527
+ 662 320 2380
kittipong.brahmasakha@
wamerelectric-ap.com

The Netherlands

**Stemin Power
Transmission**
+31 (0)673 252043
+31 (0)673 257113 &
256009
info@stemin.nl

Turkey

**BIBUS Otomasyon
San ve Tic.Ltd.Sti.**
+90 212 293 82
+90 212 249 88 34
info@bibus.com.tr

Teka Teknik Cihazlar Sanayii ve Ticaret AS

+90 212 274 5124
+90 212 272 1568
skaya@tekat teknik.com.tr

U.S.A.

Industrial Clutch Products

+1 262 547 3357
+1 262 547 2949
info@indclutch.com

Wichita Clutch

+1 940 767 2000
+1 940 723 3436
wichita.info@wichitaclutch.com

Venezuela

**TRP2800 C.A. CC y
professional Ceravica
Of. 7**
(58241) 617-2033
(58241) 825-8073
trp2800@telcel.net.ve

W Malaysia

**Altra Industrial Motion
(Singapore) Pte. Ltd**
+ 65 487 4464
+ 65 487 6674
sales@altramotion.com.sg



www.wichitaclutch.com

2800 Fisher Road
Wichita Falls, TX 76302 - USA
940-723-3400
Fax: 940-723-3436

www.wichita.co.uk

Amphill Road
Bedford MK42 9RD - UK
+44 (0) 1234 350311
Fax: +44 (0) 1234 350317